

Gas type limited edition

Economical Mass Flow Controller

1000series 1030:30SLM 1050:50SLM



Gases : Air • N₂ • Ar • H₂ • CO₂ • O₂ • He

Features

- Economical mass flow controllers for gas
- Cost effective and easy to use
- Control gas mass flow rates : 30-50SLM
- Negligible flow surge
- 0-5 Volt setpoint and flow signals

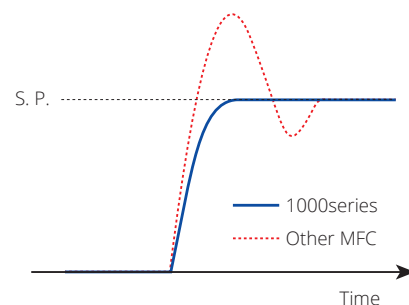

*Prevents flow surge in the initiation of the mass flow control operation.

Specification

Model	Mass flow controller : C1030/C1050	Mass flow meter : M1030/M1050
Gases	Gases (e.g., air, nitrogen, carbon dioxide, argon, hydrogen, helium, methane, oxygen)	
Valve type	Normally Open	
Flow range*	30SLM-50SLM	
Flow rate control range	5-100% F. S.	
Accuracy	±2%F. S. (Accuracy guaranteed between 15-35°C)	
Repeatability	±0.2%F. S.	
Response speed	less than 6sec	
Operating differential pressure	200-300kPa	
Pressure Resistance	1MPa (G)	
Leak Integrity	1×10 ⁻⁷ Pa·m ³ /sec (He)	
Operating temperature	5-50°C less than 85% RH	
Wetted surface material	SUS316, PTFE, Fluoro-Rubber	
Seal material	Fluoro-Rubber	
Setting signal	0.25-5VDC	
Output signal	0-5VDC	
Standard fitting**	1/4in. SWL (equivalent), One-touch fittings	
Drive power source	+15VDC ±5% 60mA, -15VDC ±5% 150mA	
Communication	Analog 0-5VDC	
Connector	9pin D-sub male	

* At FCON, flow rates (SCCM, SLM) are converted to values at 0°C, 101.3kPa abs (1atm) for calibration.

** For other fitting, please contact us.

Dimensions

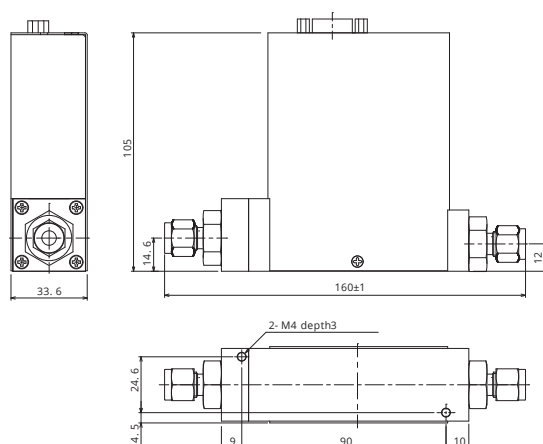

C1030/M1030

Face to face dimensions

C1050/M1050

1/4in. SWL (equivalent) : 160mm

One-touch fittings : 169mm

Ordering

C 1050 – **4S2** – **50L** – **N2**

1 2 3 4 5

1. Type

C : Mass flow controller
M : Mass flow meter

3. Fitting*

4S2 : 1/4in. SWL (equivalent)
KQ2 : One-touch fittings

5. Gas type

Air • N₂ • Ar • H₂ • CO₂ • O₂ • He

2. Series

1030 : 30SLM
1050 : 50SLM

4. Full scale

30L : 30SLM
50L : 50SLM

*Consult factory for other fittings.

FCON, CO., Ltd. #109 Nankoku Office Park Center, 1-1-1 Hotarugaoka, Nankoku-shi, Kochi, 783-0060, Japan

Tel +81-88-855-7100 . Fax +81-88-855-7166 . contact@fcon-inc.jp . http://www.fcon-inc.jp

• The contents of this catalog are subject to change without notice.

20170515